

# Premium Slide

## Assembly Guide

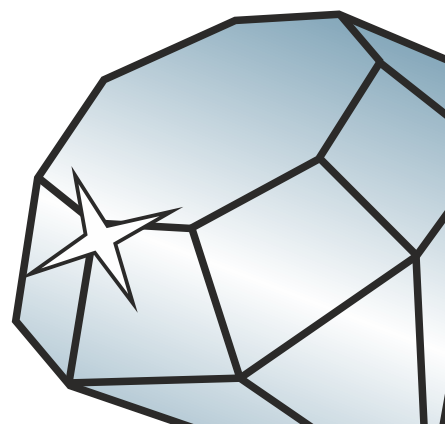

DURATION  
WINDOWS



## Contents

<b>3</b>	Box Contents
<b>4</b>	Assemble 2 Track Outer Frame
<b>5</b>	Assemble 3 Track Outer Frame
<b>6</b>	Head Extension & Drip Bar
<b>7</b>	Optional Water Collector
<b>8</b>	Thermal Shield 2 Track
<b>9</b>	Thermal Shield 3 Track
<b>10</b>	Cover Plates
<b>11</b>	Low Threshold
<b>12</b>	Keep Assembly
<b>13</b>	Inserting Panels
<b>14 - 17</b>	Anti Lift
<b>18 - 19</b>	Fixed Panels
<b>20</b>	Fixing Straps

# TBC

**IMPORTANT:** Ensure that the frame is  
fitted plumb, square & level with no bows



We reserve the right to make changes to the product specification as technical developments dictate, and without prior notice.  
Pictures shown are for illustrative purposes and are not binding in detail, colour or specification.

# Outer Frame - Two Track

## 3610 - Double Track Outer Frame Assembly

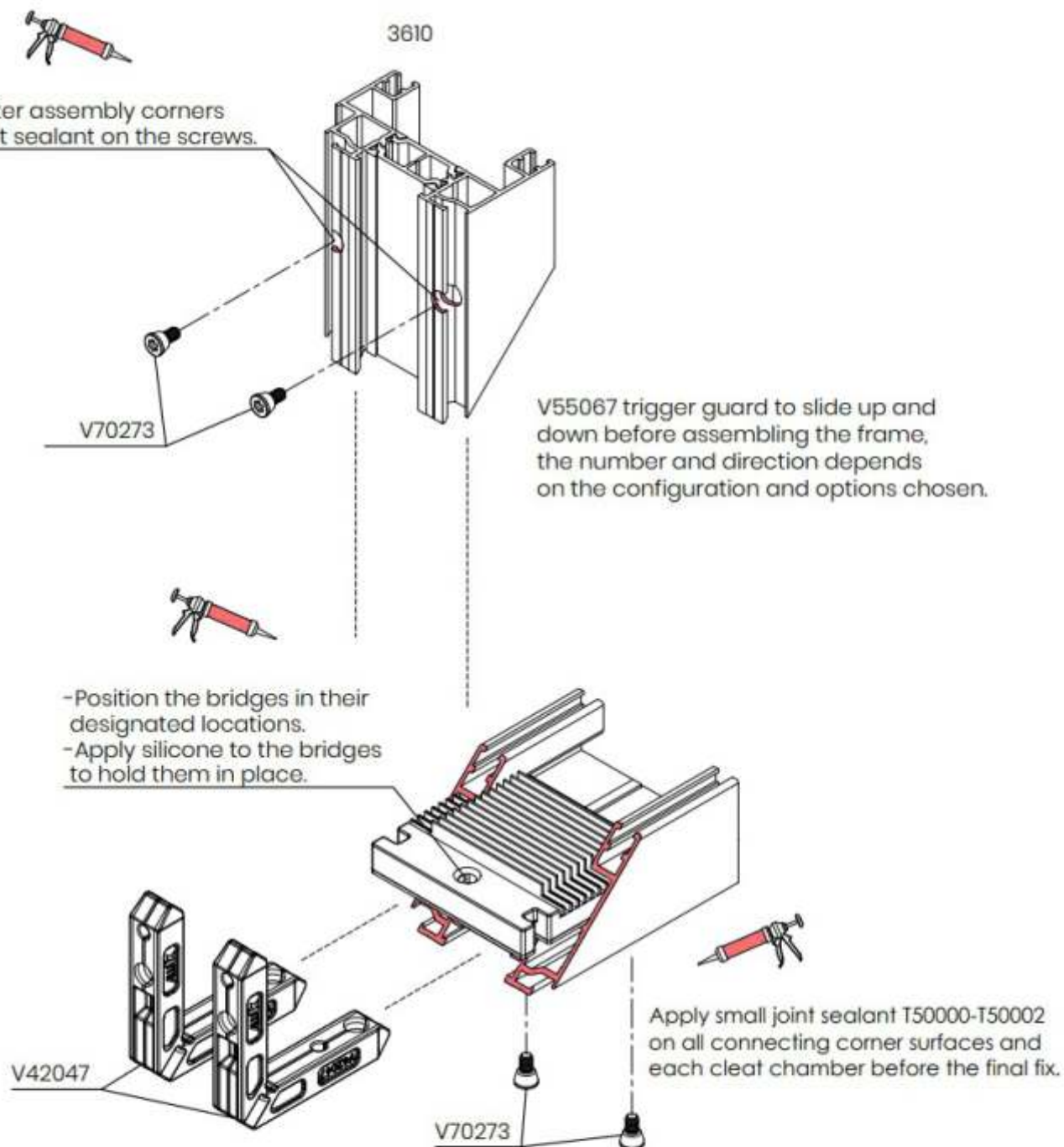

**NB:** Remove excess sealant with Aluk small joint sealant wipes (T50003)



# Outer Frame - Triple Track

## U03062 - Triple Track Outer Frame

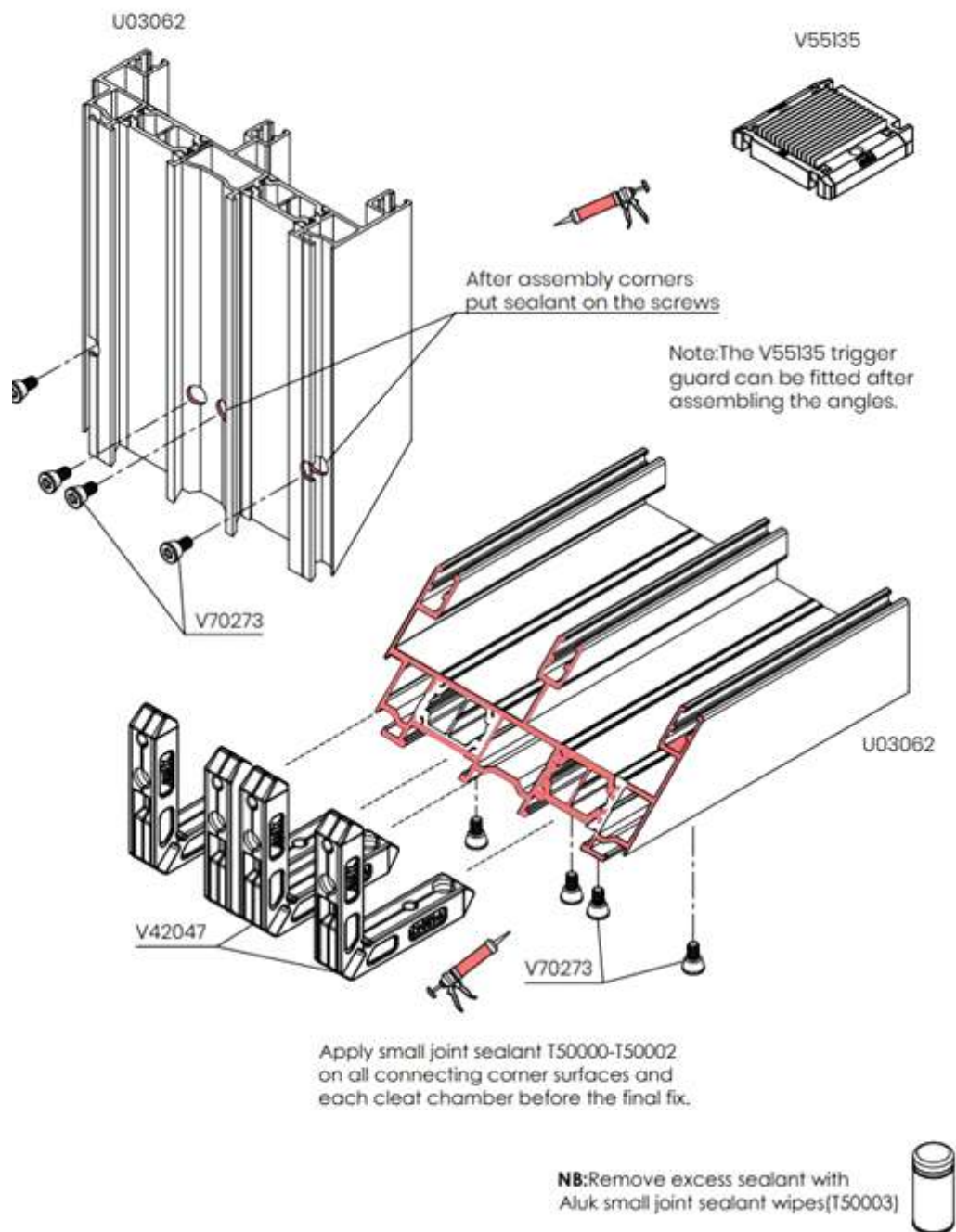

# Head Extension & Drip Bar

Fix 2 Part Head Extension With V6001

Fix TW118 Drip Bar Into Position

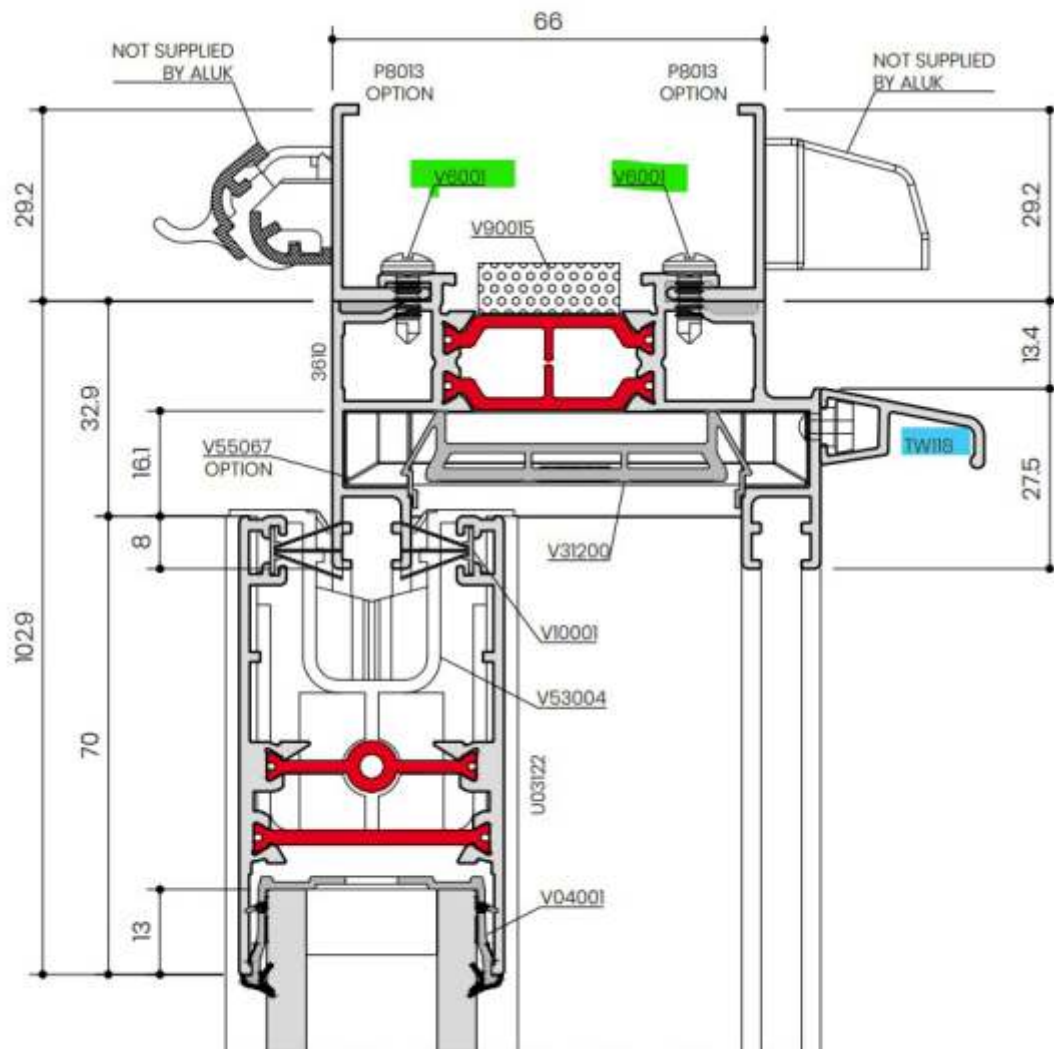
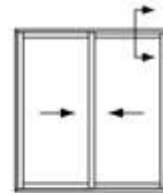

Duration Windows reserve the right to make changes to the product specifications as technical developments dictate, and without prior notice. Pictures shown are for illustrative purposes and are not binding in detail, colour or specification.

# Optional Water Collector

## ► N05630 - Water Collector

To install the water collector and its plugs securely on the low transom frame, it is essential to pre-drill the necessary holes in the water collector and trim a portion of the plugs beforehand.

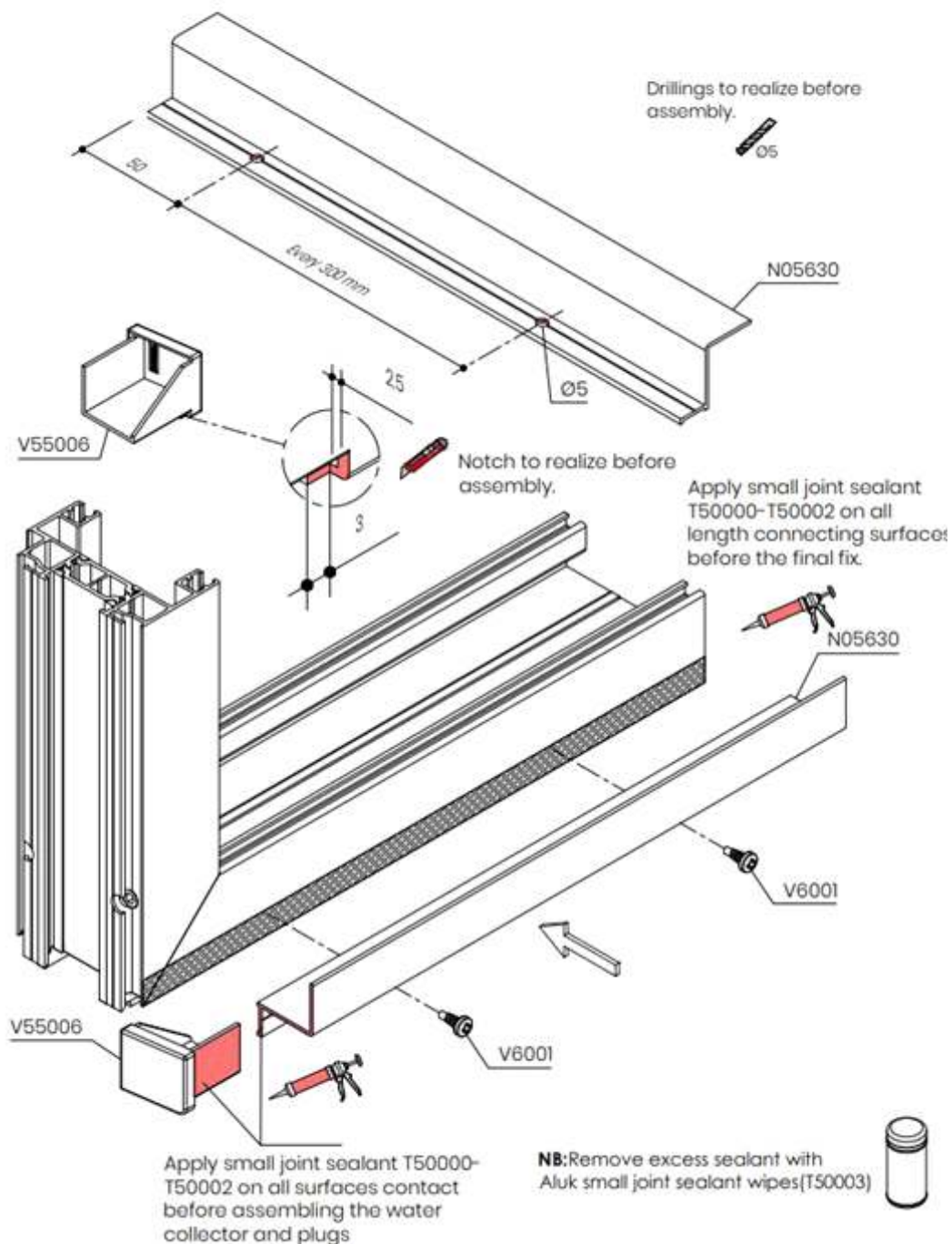



# Thermal Shield - 2 Track

## ➤ V31200 - Thermal Shield

Insert PVC Thermal Shield (V31200)

Add Foam To Back Of Outer Profile (V90015)

\* Slide into profile before the corner assembly.

\*\*Prior to assembly, peel off the paper covering the adhesive and securely attach the foam around the outer profile on the polyamide.

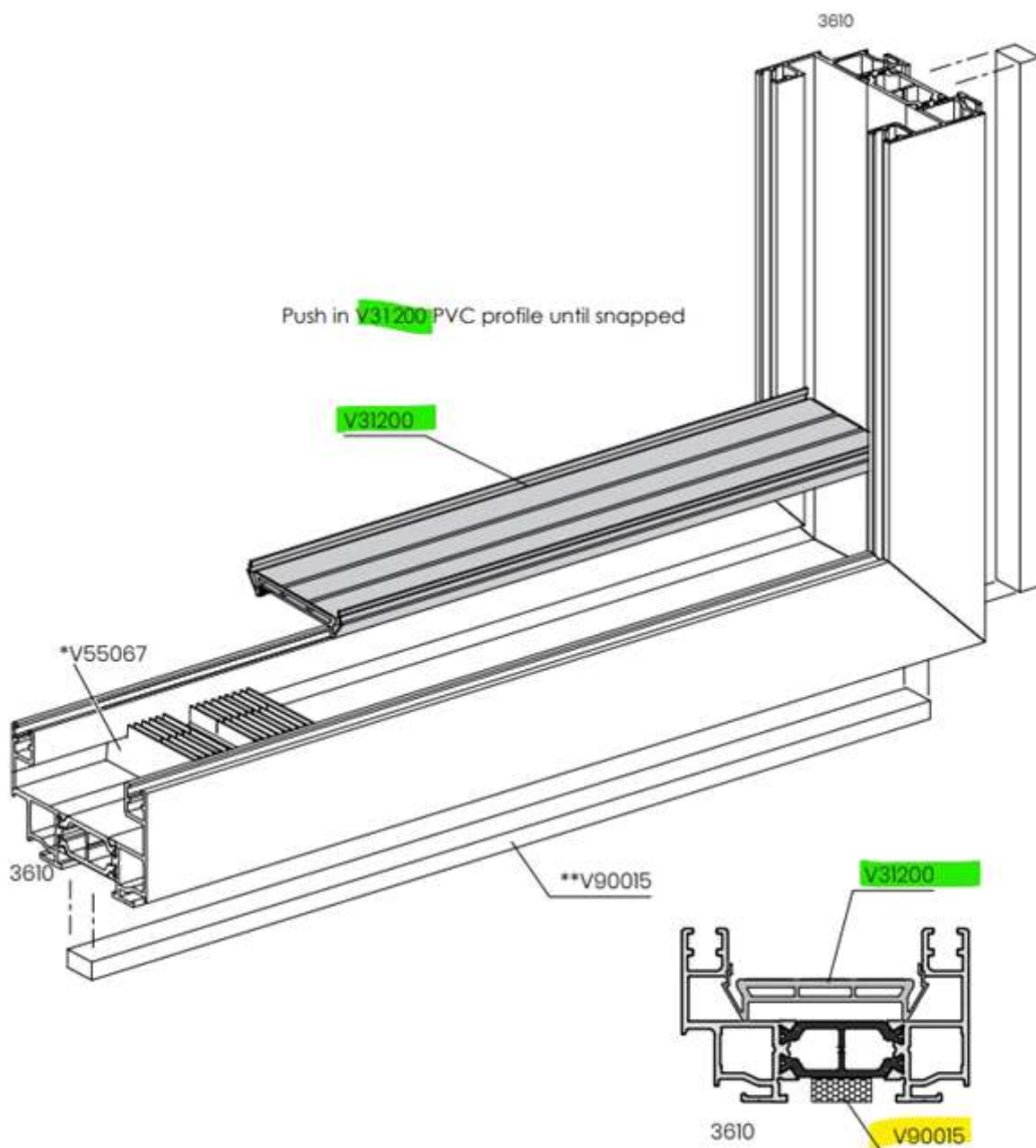



# Thermal Shield - 3 Track

## ➤ V31200 - Thermal Shield

Insert PVC Thermal Shield (V31200)

Add Foam To Back Of Outer Profile (V90015)

Trim 36011 Plug For Positioning on 3 Track Frame

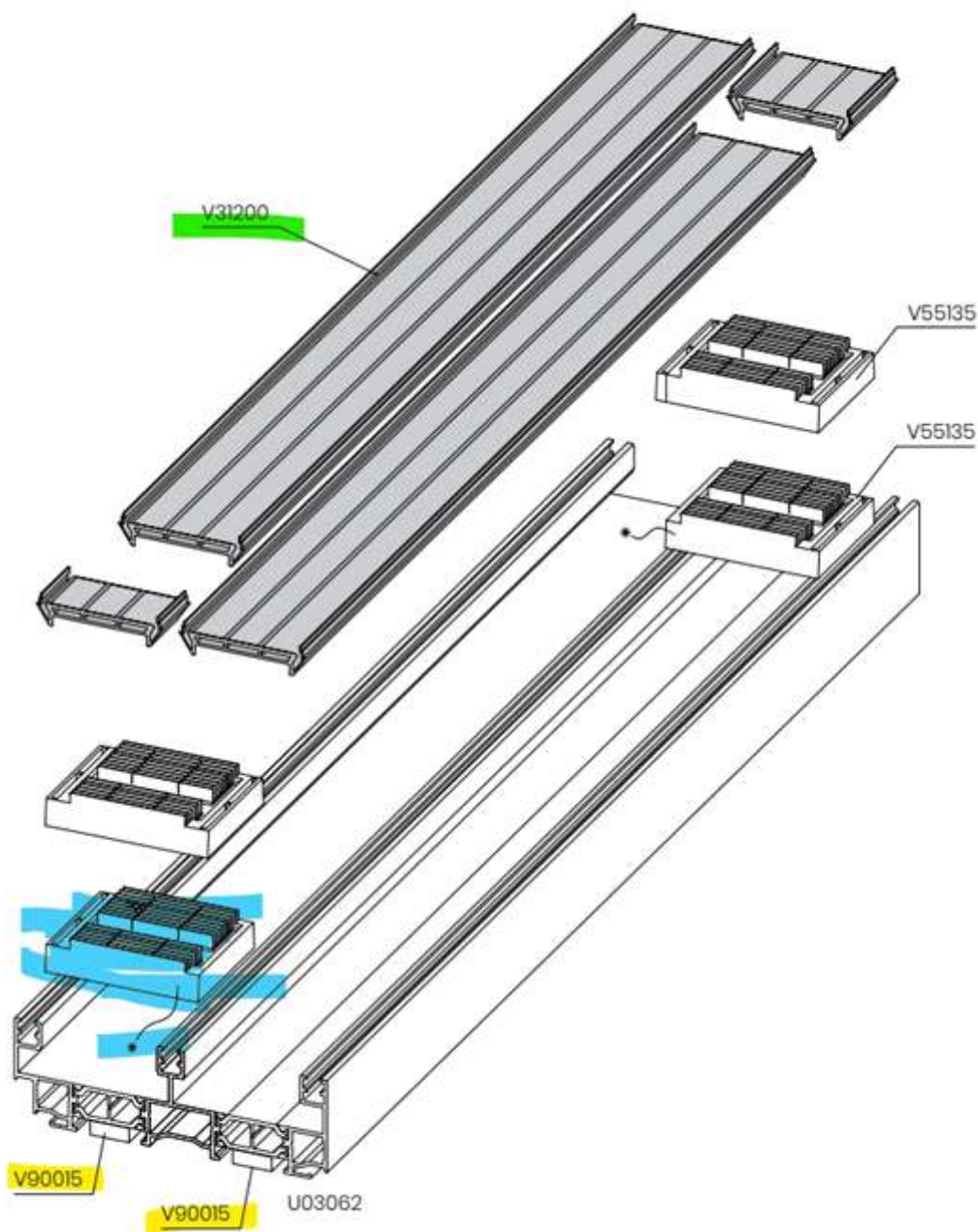

\* Note: Trim 36011 plug for proper positioning on the three-track frame U03062.

# Cover Plates - 2 & 3 Track

## ➤ Cover Plates - N03653, N03917

Add Remaining Thermal Shield V31200

Add Cover Plates (N03653 N03917)

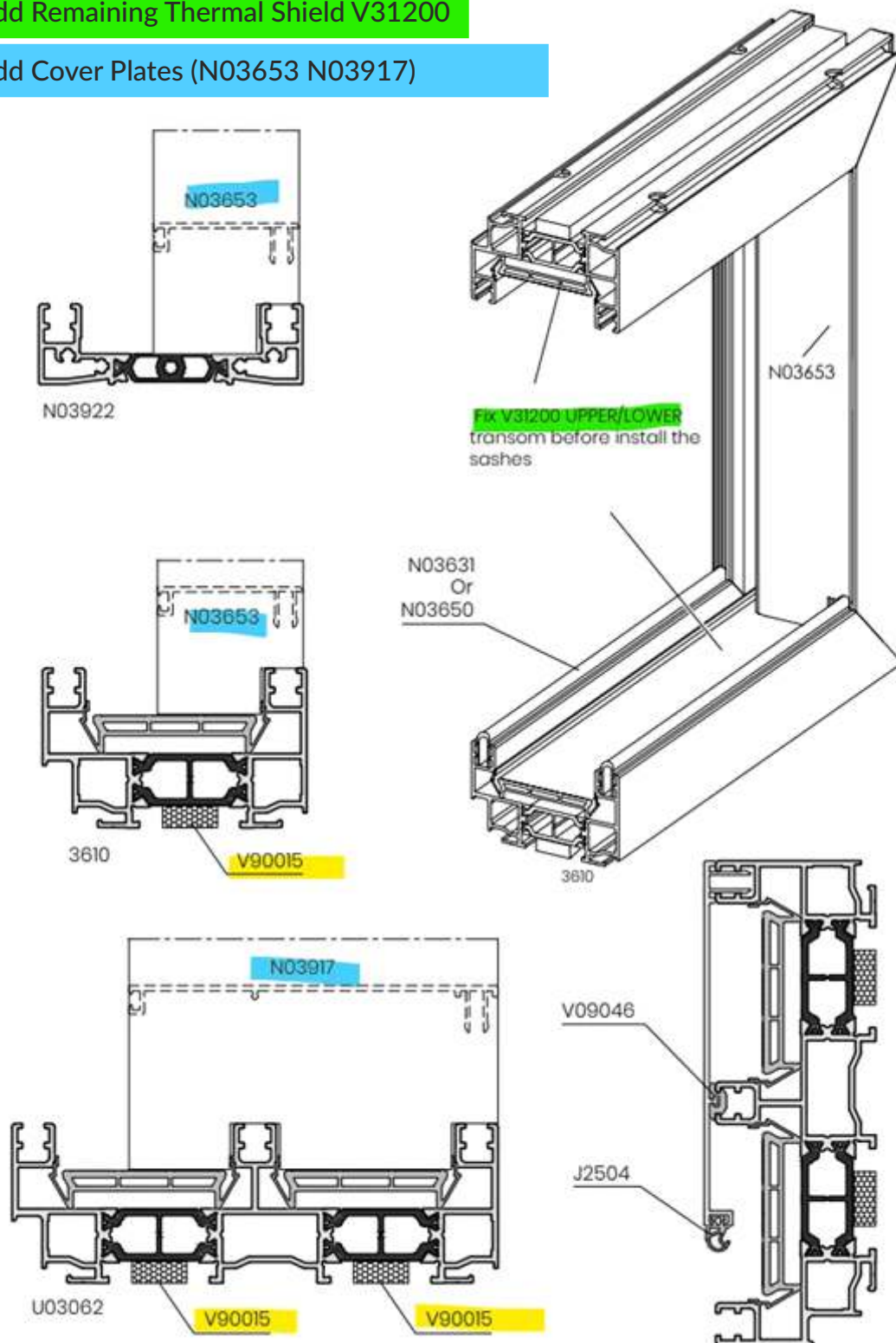

Duration Windows reserve the right to make changes to the product specifications as technical developments dictate, and without prior notice. Pictures shown are for illustrative purposes and are not binding in detail, colour or specification.

# Low Threshold Assembly

## Low Threshold - U03922

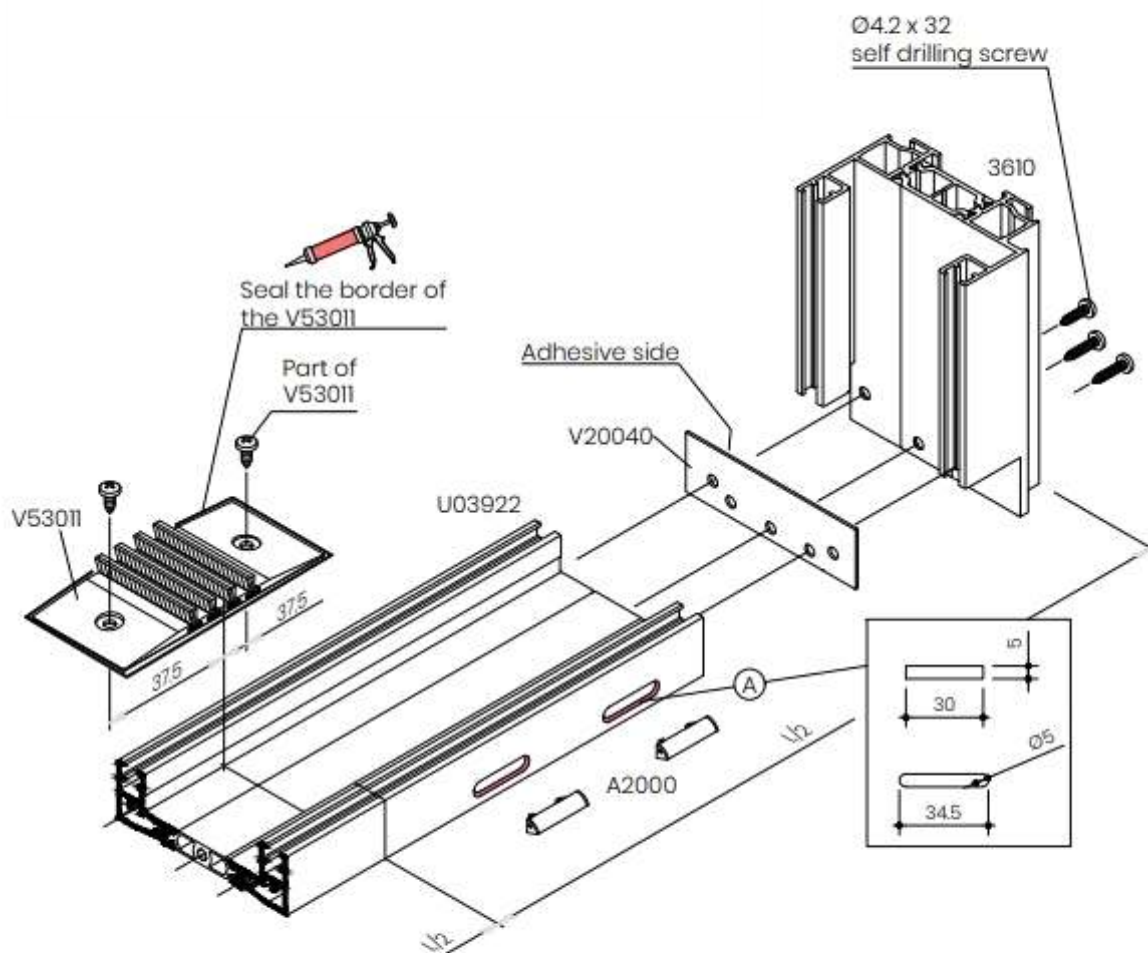

- On hole 'A' install water drainage A2000
- On exposed side, remove the internal fin to facilitate the deflow of water
- Apply small joint sealant T50000-T50002 on hole 'D' and fill the tubular with silicone

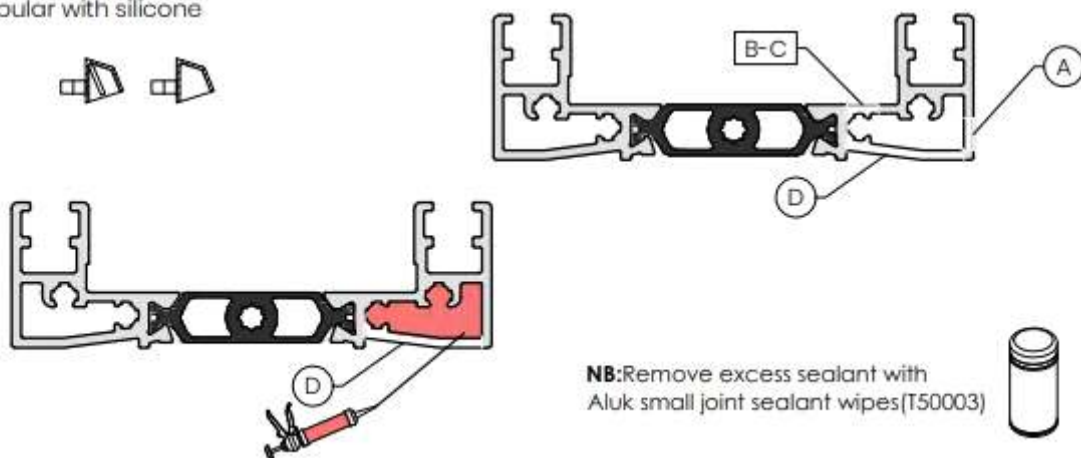

## Position H03416 Strikes

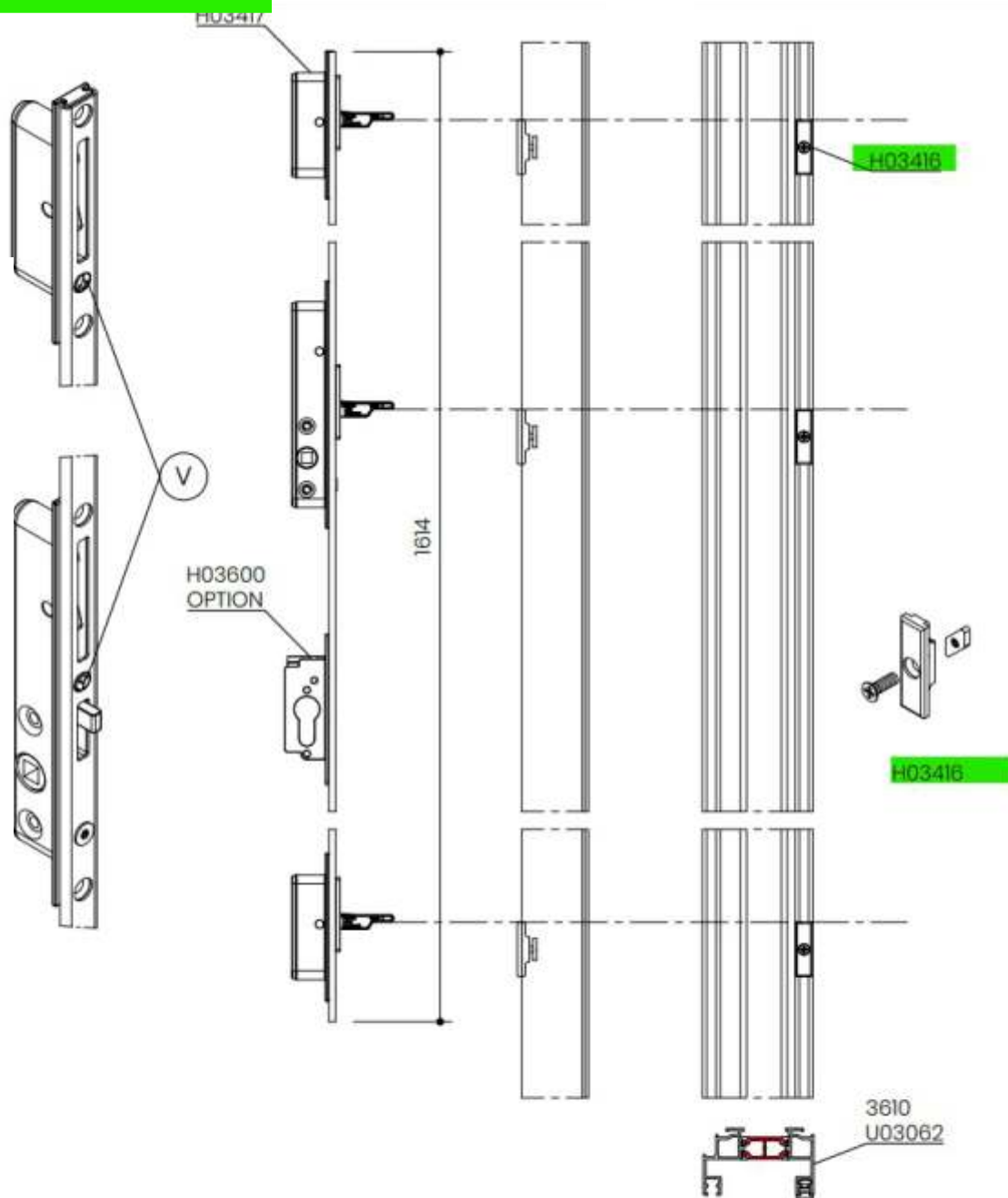

- The secure+ H03417, when fitted as standard, combines with the H03416 strikes.
- To position the strikers, use the template supplied with the lock (see figure above) then tighten them.
- Possibility of varying the penetration of the hooks into the strike plates by 2 mm (refer V).

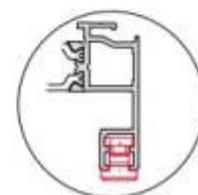

**Figure 1**

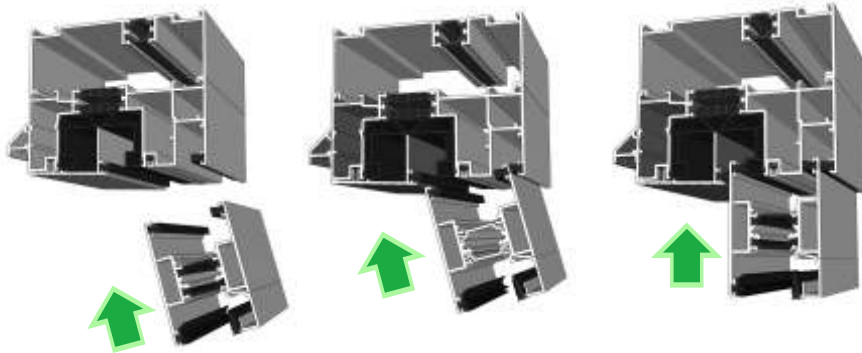

- Locate top of door sash to head of outerframe (figure 1).
- Check the angle of insertion, too big or too small will result in damage.
- Insert Sash into outerframe head
- Swing bottom of sash into lower outerframe track.(figure 2).

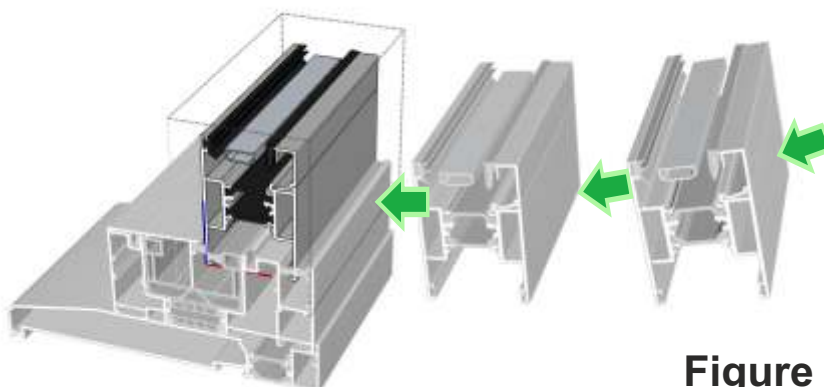

**Figure 2**



# Anti Lift Assembly

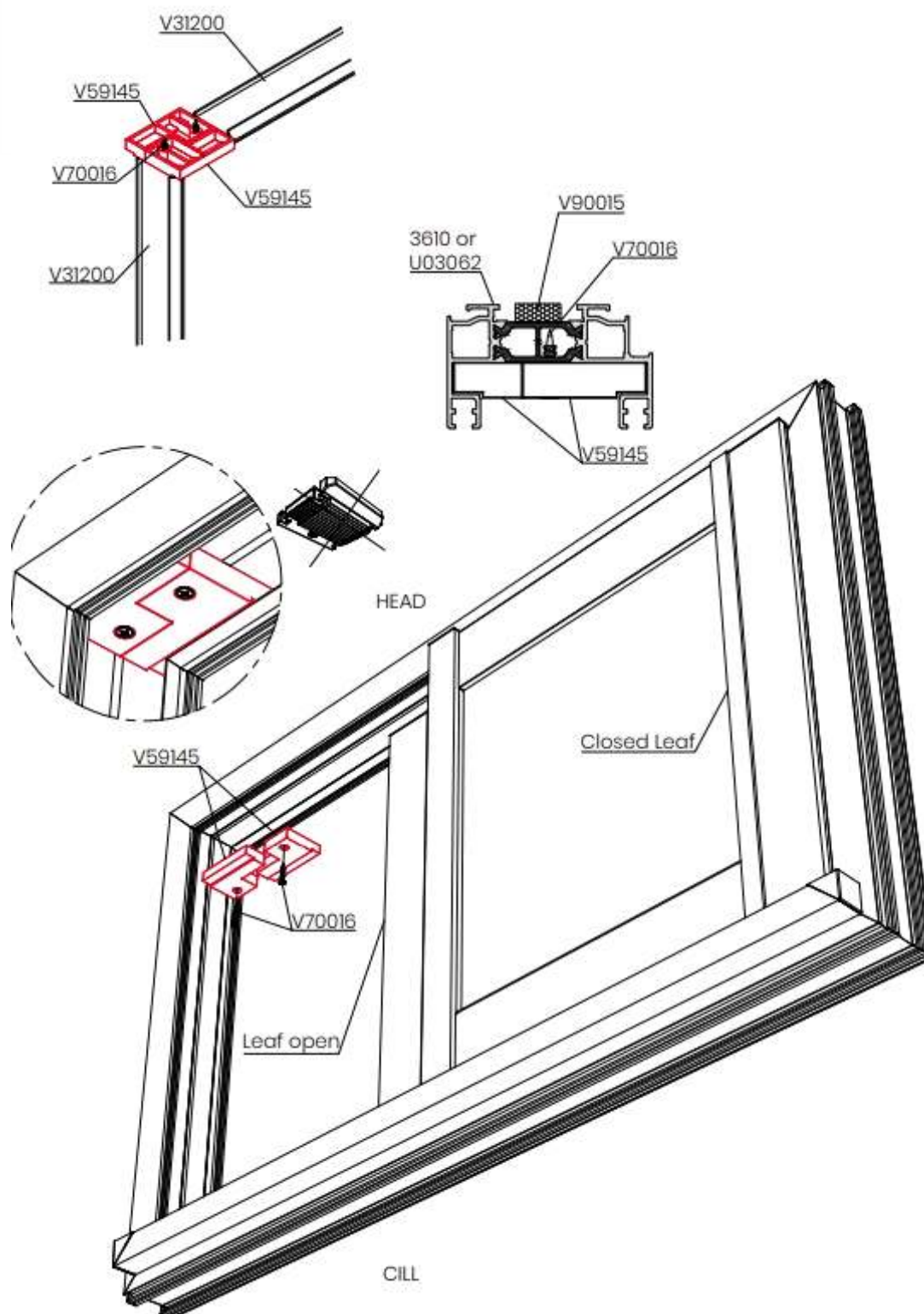

Duration Windows reserve the right to make changes to the product specifications as technical developments dictate, and without prior notice. Pictures shown are for illustrative purposes and are not binding in detail, colour or specification.



## Anti Lift Assembly

Ensure careful attention to the direction,  
with the cap positioned beneath the leaf.

Secure it in place using a V70016 screw.

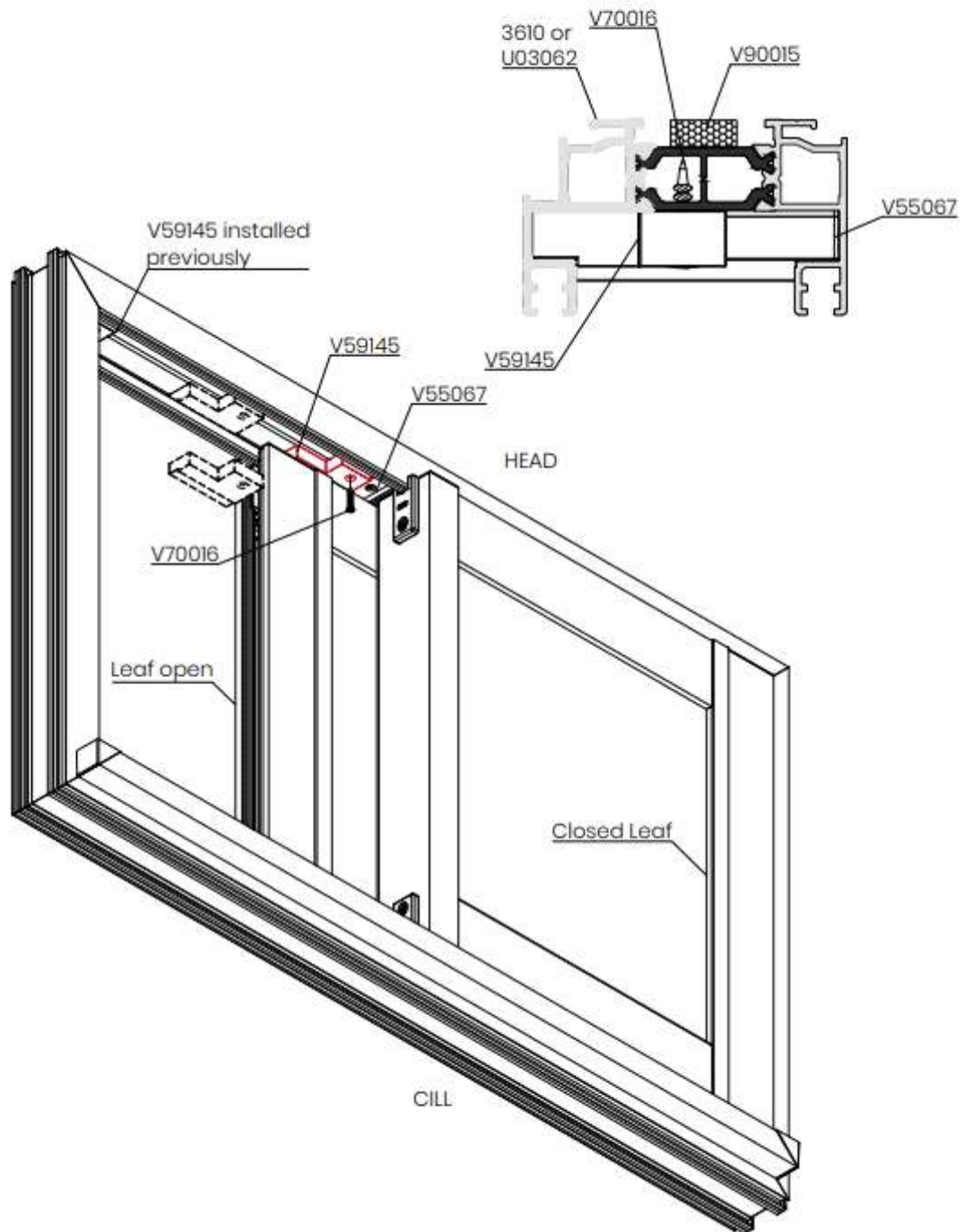

# Anti Lift Assembly

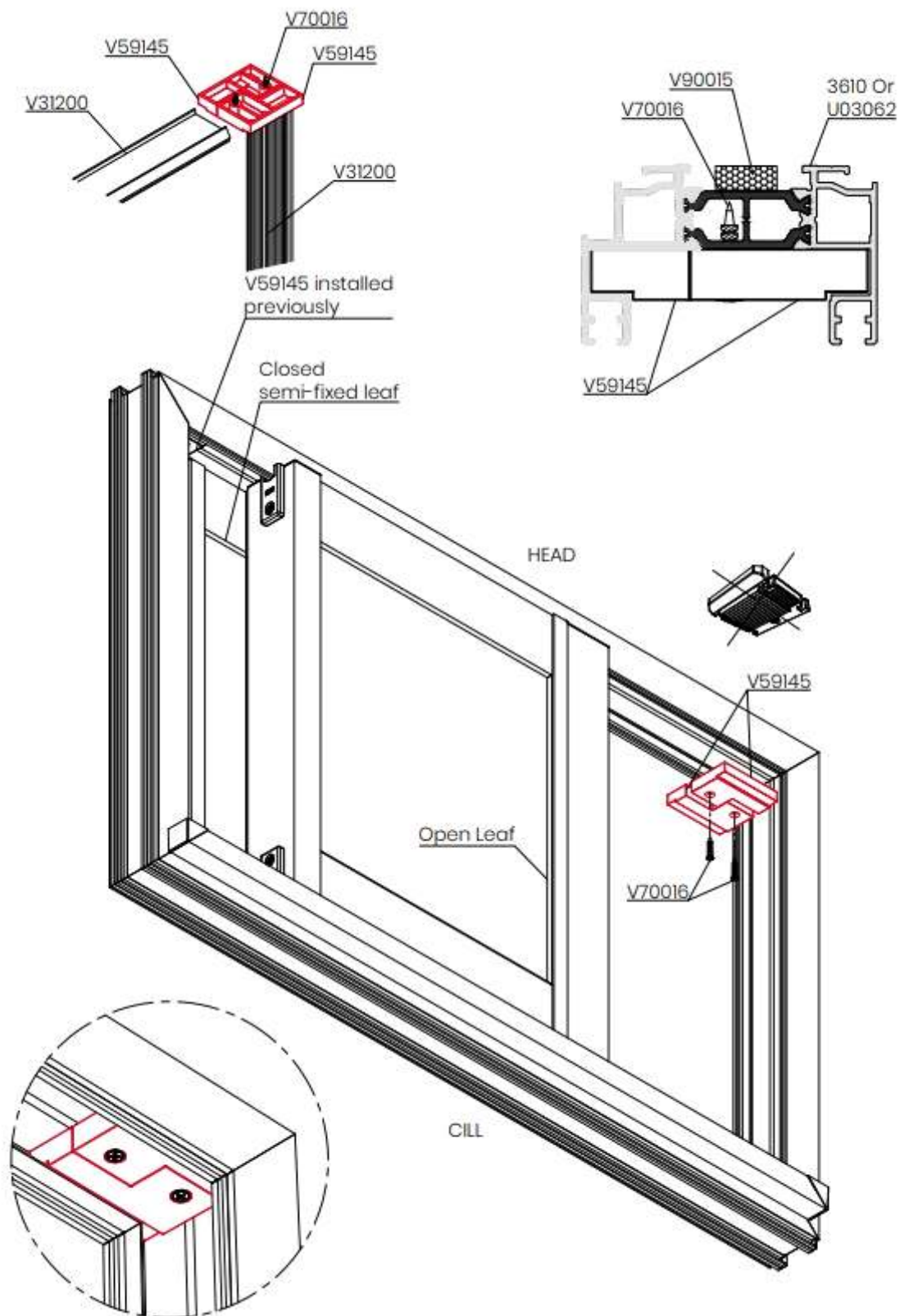

Duration Windows reserve the right to make changes to the product specifications as technical developments dictate, and without prior notice. Pictures shown are for illustrative purposes and are not binding in detail, colour or specification.

## Final Positions

After installing all anti-lift plugs (V59145), proceed by securely clipping in V31200

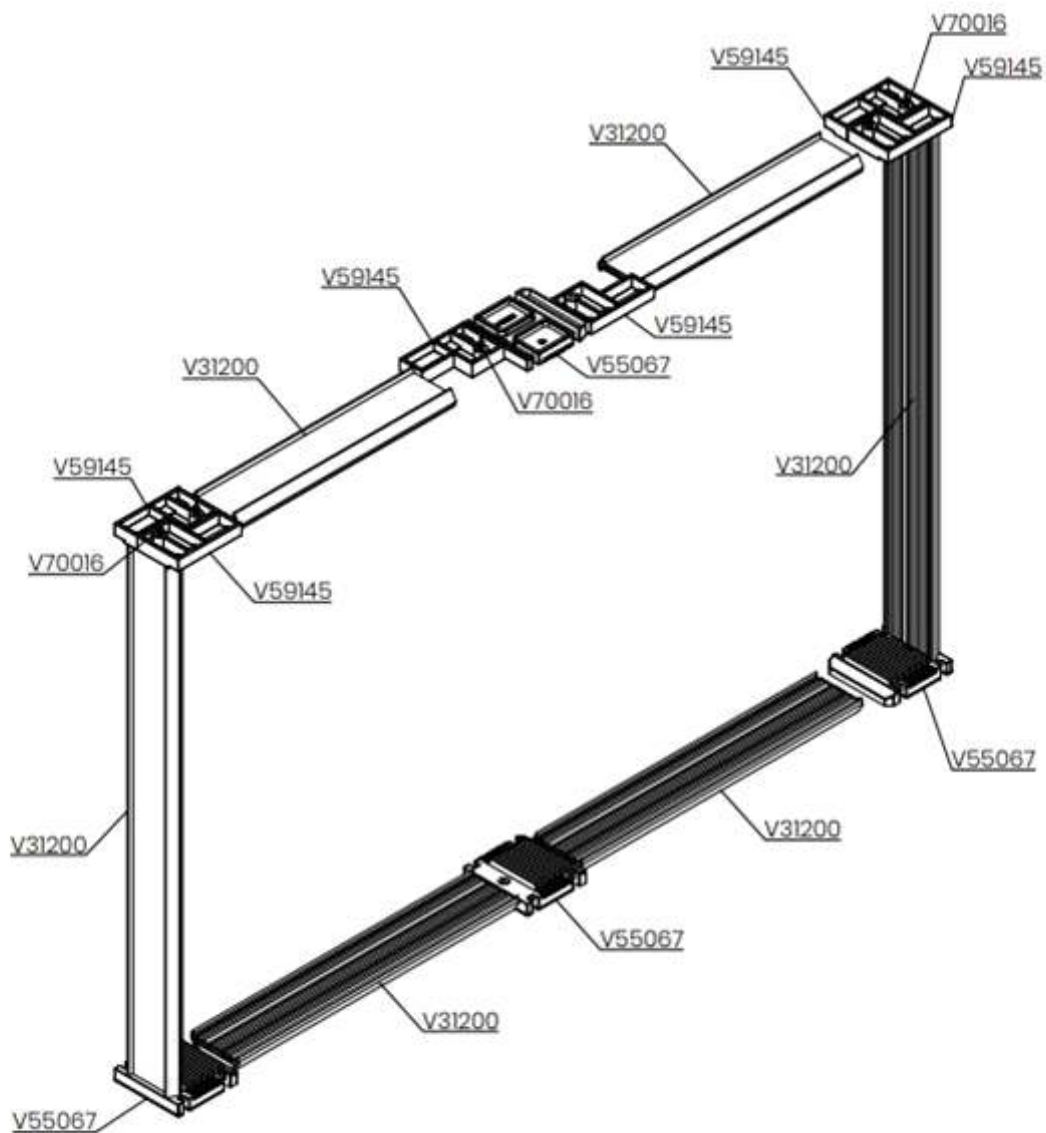

# Fixed Panels

## Assembly of H03602 Fixed Sash Bracket

### Step 1.

Remove V53004 end cap from top/bottom of lock stile. Slide in H03602 backing plate between the thermal break and Aluminum C-channel. Position 100mm from the end of the lock stile and centrally (3 in total per lock stile).

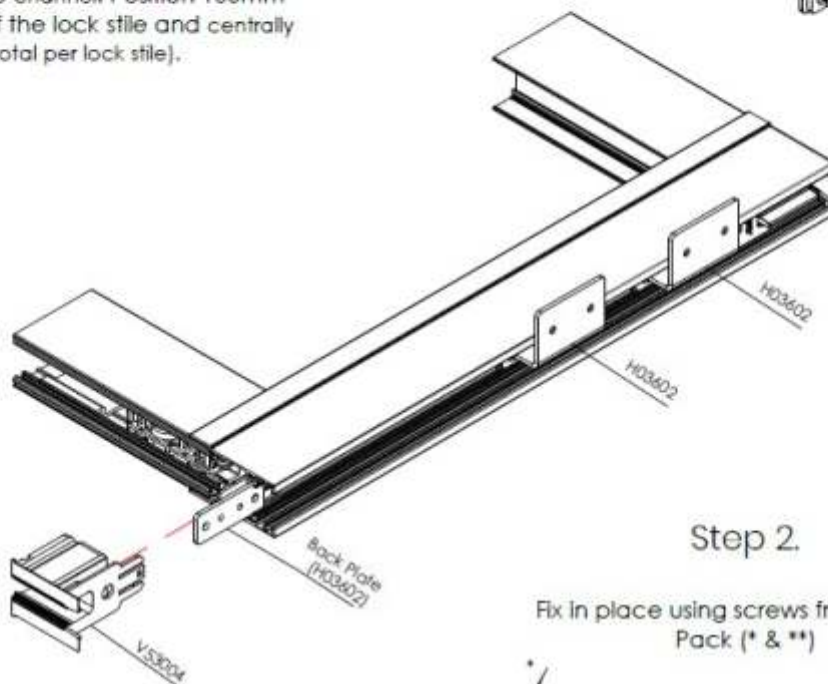
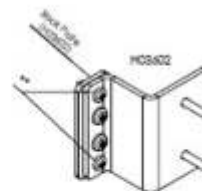

### Step 2.

Fix in place using screws from H03602 Pack (\* & \*\*)

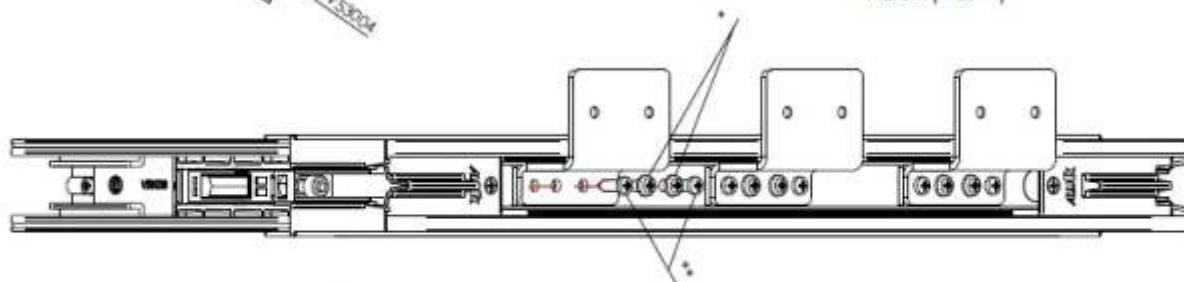

- \* Ø4.3 X 16mm Pozi. Pan S/Tapping screw
- \*\* M5 X 10mm Pozi. Pan head machine screw

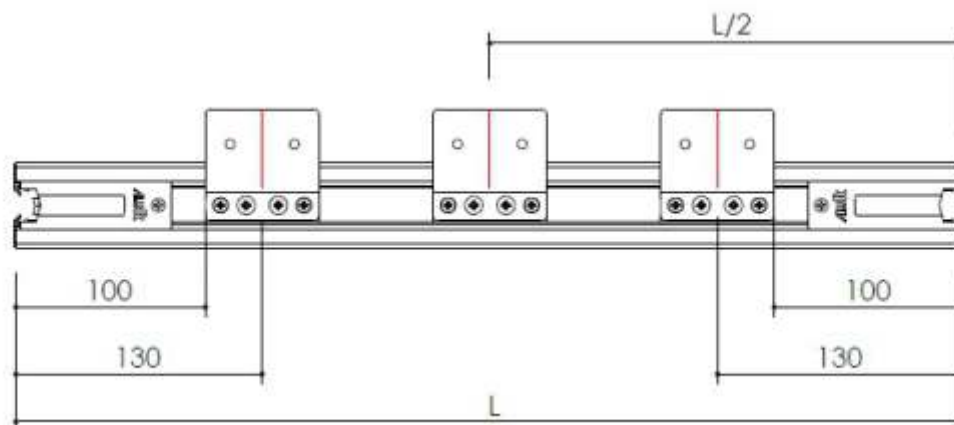

Duration Windows reserve the right to make changes to the product specifications as technical developments dictate, and without prior notice. Pictures shown are for illustrative purposes and are not binding in detail, colour or specification.

# Fixed Panels

## ► Assembly of H03602 Fixed Sash Bracket

### Step 3.

Lift door sash into the outer frame and slide into the closed position. H03602 fixed panel bracket should be touching the thermal break of the outer frame when in the correct located.

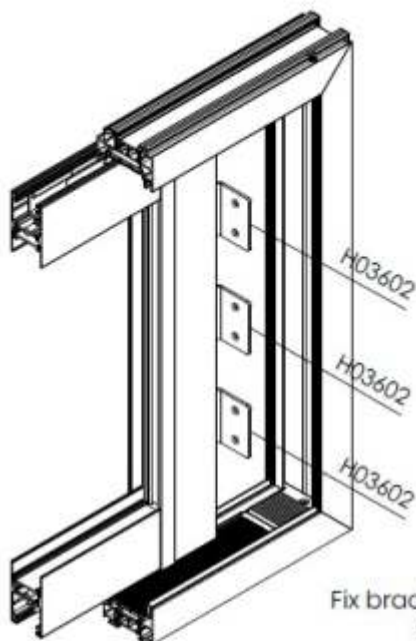

### Step 4.

Fix bracket in place using screws from H03602 pack

- \* Ø4.2 x 25mm counter sunk pozi s/tapping screw

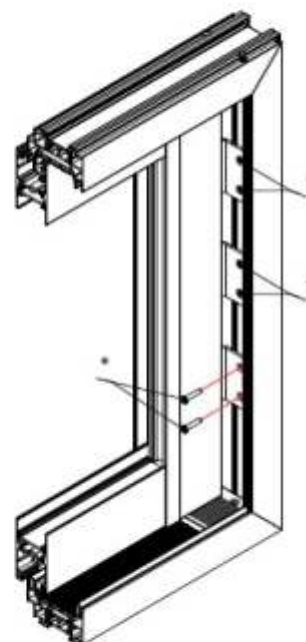

### Step 5.

Insert V31200 with Pre-machined slots into the outer frame, covering the H03602 brackets already screwed in place.

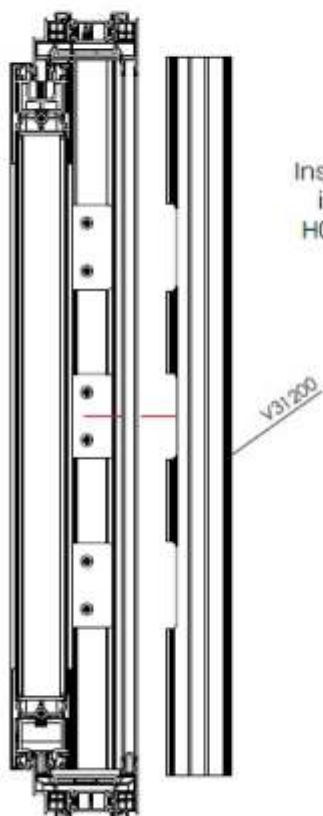

### Step 6.

Finally, clip N03653 (including the gasket J2504) into the channel in the outer frame. Closing off the opposing side of the outer frame to the fixed sash.

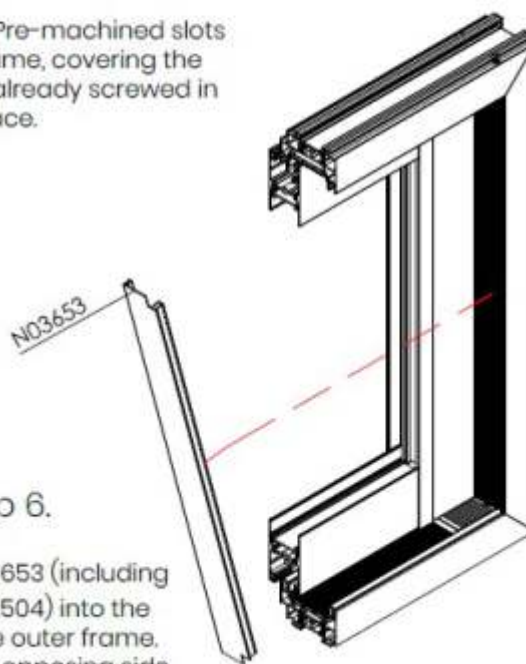



# Fixing Lugs

## Fixing Lug - V72086

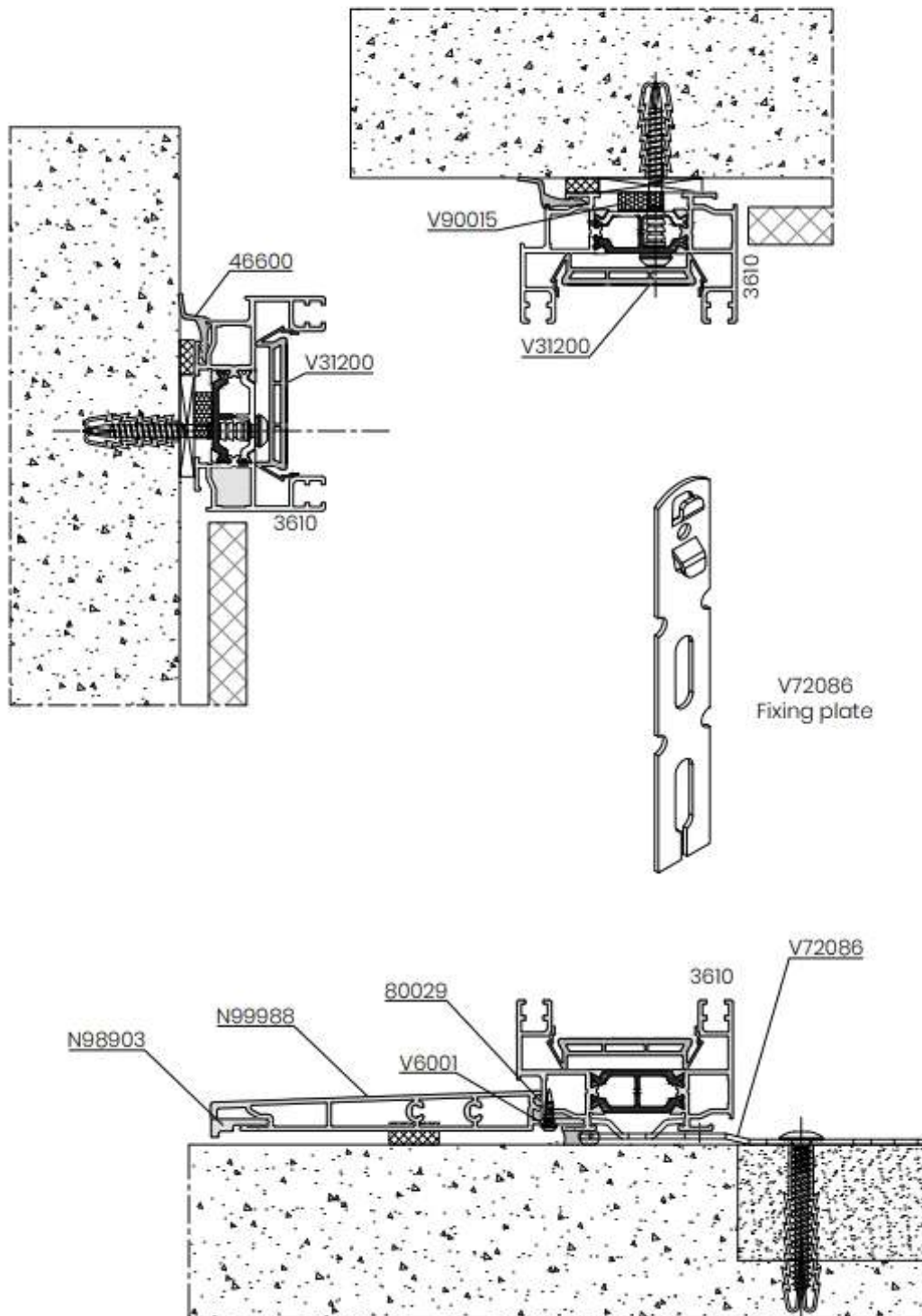



**Main Office, Factory & Showroom**

Units 4-5,	01268 681612 (20 lines)
Charfleets Road,	<a href="mailto:sales@duration.co.uk">sales@duration.co.uk</a>
Canvey Island,	<a href="http://www.duration.co.uk">www.duration.co.uk</a>
Essex. SS8 0PQ	